

a+

architecture plus

Architecture of a New World

GCC Middle East Asia Africa Indian Subcontinent



16 CULTURE CAPITAL

Abu Dhabi's Saadiyat Island, United Arab Emirates

ARCHITECTURE Abu Dhabi looses all inhibitions in its race to become one of the culture capitals of the world with four iconic projects: the Abu Dhabi Guggenheim by Frank Gehry + Louvre Abu Dhabi by Jean Nouvel + Performing Arts Centre by Zaha Hadid + Maritime Museum by Tadao Ando + more **HOUSES** Three diverse and distinct designs from India, Canada and China **INTERIOR DESIGN** Statement-making interiors that stand out from the crowds **COMMUNITY & PLANNING** The world's first carbon-free city + more **LANDSCAPE DESIGN** Competition-winning design of the edu-environmental park in Mexico City + more **GREEN ARCHITECTURE** The world's first house to be completely lit by LEDs + The 24th IALD Awards + more **CONSERVATION** The multi-award winning Hotel Condesa df **PRACTICE** Vaastu Shastra + industry news + more

UAE AED 50.00 GCC US\$ 13.50 Middle East US\$ 15.00 India US\$ 10.00 UK GBP 9.00 Europe Euro 12.00 World US\$ 17.50



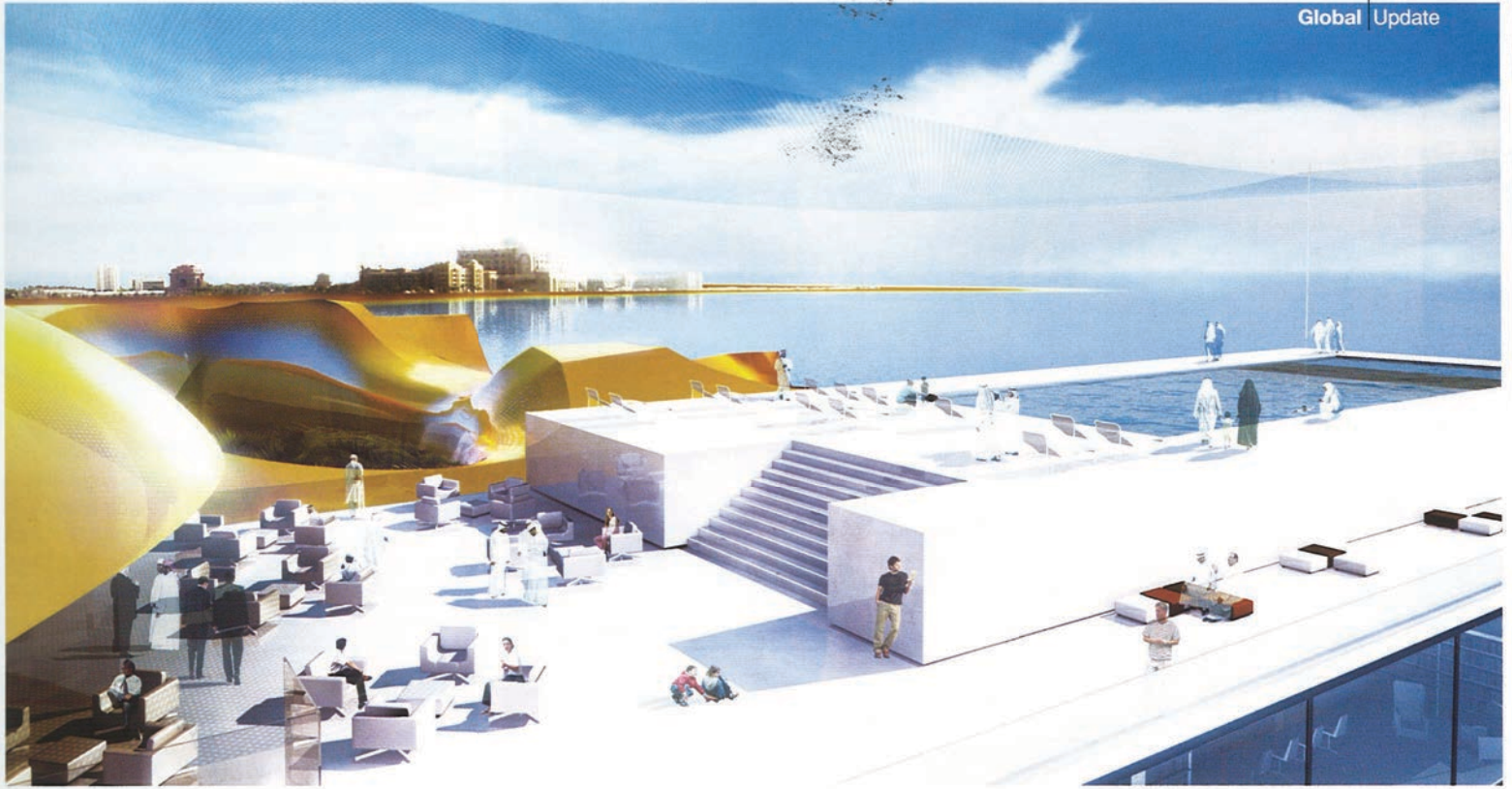

UAE Desert delight

The proposed design from Carbondale, the Paris-based architectural office, for the Abu Dhabi Plaza Building on the Abu Dhabi Breakwater Island aims to participate as one of a series of remarkable symbolic monuments that line the coast of the island including the Presidential Palace, the Mosque and the Marina among others.

Merging the eternal with the contemporary, the Plaza building resonates equally day and night. Its lines and curves reminiscent of a desert landscape create simple fluid volumes that flow together into a distinctive singular character expressing both sense of place and cultural identity. At its centre lies the 'Urban Plaza'. A meeting place for visitors and residents alike, the Plaza is covered by a horizontal shade composed of geometric patterns and serves as a forecourt to the boutiques while providing space for exhibitions and events within an air-conditioned environment enclosed by transparent glass walls. This element of transparency reinforces the sense of complete openness of the entire Plaza and with visual connections maintained in all directions, a constant sense of orientation is achieved. Furthermore, by looking upwards, the sky is rediscovered through the foliage of the forest of palm trees planted within the central interior garden. The 25-metre high curved reflective glass walls distort the limits and multiply the greenery in a large ovalar space while providing a garden for the offices and interior apartments to look onto.

On the roof terrace, a new experience awaits. The sculpted forms of the building's roofscape echo the topography of the desert dunes while unveiling an array of facilities including the cantilevered swimming pool that reaches towards the ocean, the health centre and a panoramic restaurant topped by a prominent iconic golden dome. Images: Carbondale

